

Wireless Radon & CO² Sensor

The ideal choice for office buildings, schools and kindergartens

The new Obeo MMA makes it easy to remotely monitor radon and/or CO₂ levels in indoor areas and buildings. The MMA utilises the GSM/GPRS cellular network to relay the sensor data to a central server available from any PC/Mac/Ipad.

You may set up one MMA in one room/area or thousands in as many rooms/buildings as you require. Access to your wireless sensors is established through a secure login site.

Ideal for building and property owners to monitor all their office buildings, schools, kindergartens, theatres and other indoor areas where people work, play, rest and live.



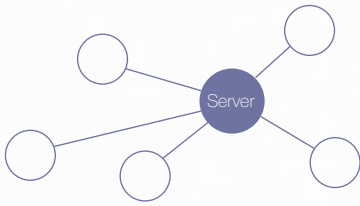

Worldwide Sensor Network

With the MMA wireless GSM/GPRS sensor network platform, you easily can monitor all your buildings' indoor air quality with reliable sensor nodes that offer industrial ratings and local analysis capabilities. Each wireless network can scale from one to thousands of nodes and seamlessly integrate with existing databases and control systems.

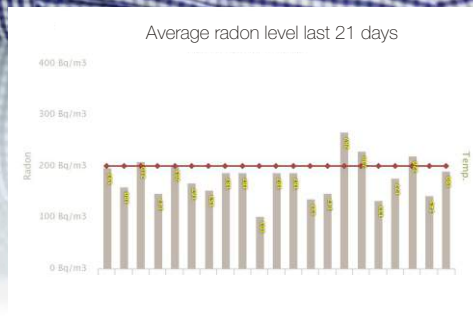
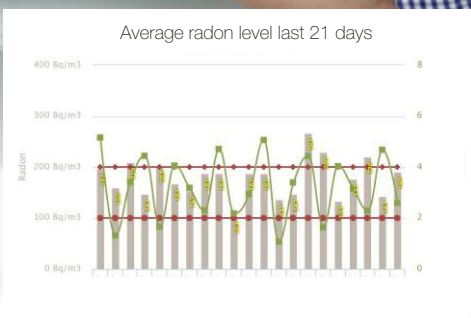

Installation and setup

The MMA comes with a pre-installed SIM-card¹ and is easily and quickly installed. Please perform the steps described below and the unit will be ready to report instantly!

- | | |
|-------|--|
| First | Find a suitable place indoors ² |
| 2. | Make a note of the ID number |
| 3. | Send ID to CitiSens |
| 4. | Mount a screw onto the wall (h=150cm) |
| 5. | Place the MMA |
| 6. | Connect the power cord to the MMA |
| 7. | Plug the cord into a wall outlet |
| 8. | Observe that the indicator flashes |
| 9. | Unit is ready when indicator is lit |

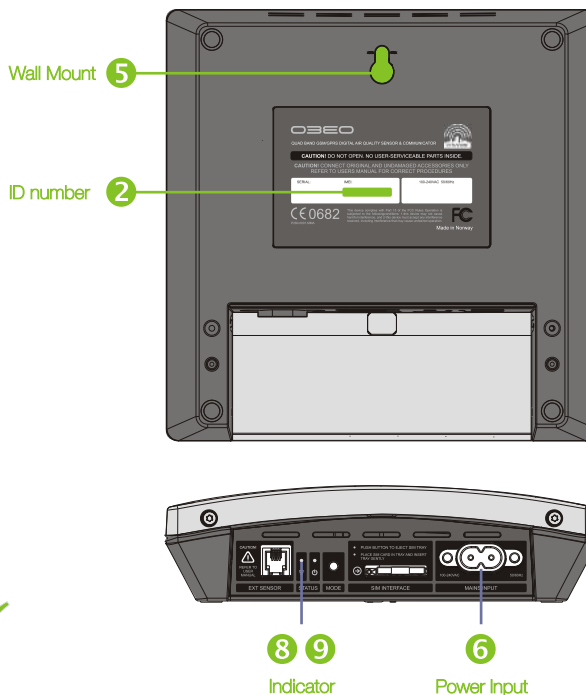

¹ If SIM-card is not installed, please eject SIM tray and insert a SIM-card before connecting power cord.

² Place away from windows, doors and ventilation openings.

Specifications

Radon Sensor	Silicon detector
Cell Voltage	250VDC
Resolution	1Bq/m ³
CO ² Sensor	Non-Dispersive Infrared (NDIR)
Accuracy 0-5000ppm	<50ppm ±3% of measuring value
GSM Bands	850-1900MHz: GSM/EGSM/DCS/PCS
Antenna	Integrated Quad Band Antenna
Operating Temp.	5°C – 35°C
Dimensions WxHxD	180x180x48,5mm

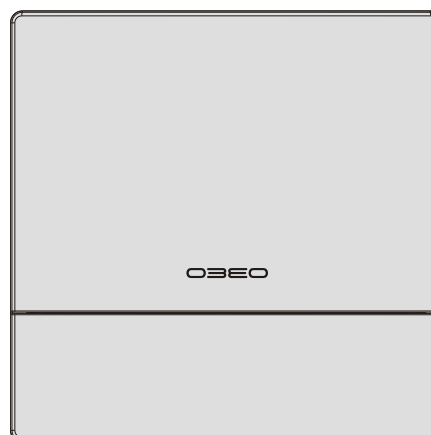

Specifications subject to change without notice.